



Vertical Garden Hardware

Scalable components that utilize our Varden Trays and Sleeves in moveable vertical gardens for restaurants, retail/grocery display and balconies/patios

Our **Varden** hardware packages feature easy assembly and set up for any Garden Center, Grocery Store, Restaurant or Residence, plus they work with **Varden** Trays and Sleeves.



Varden A-Frames



Varden Kit Racks

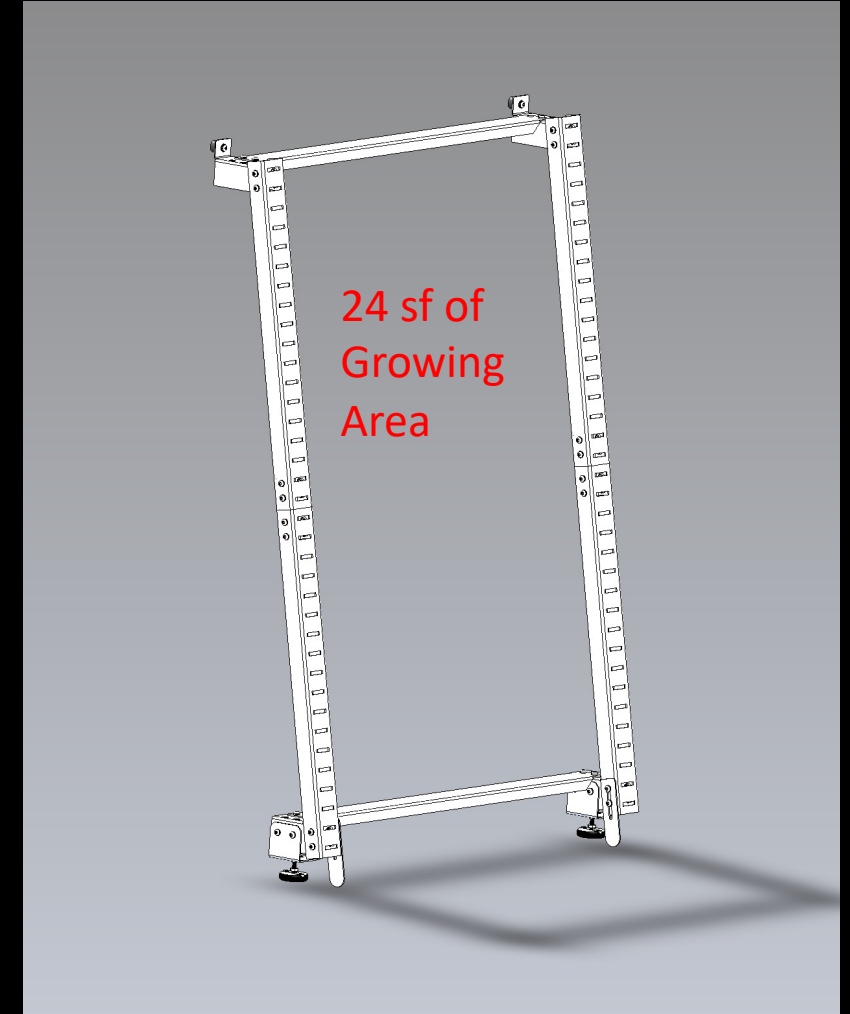

Varden Leaning Gardens

The Vertical Garden Rack:

The perfect way to mount our Varden Kit in small spaces where a wall mount is not desirable. Place this 2' wide x 5' tall free-standing rack anywhere and get growing..... accepts grow lighting and works with our **Varden** Trays and Sleeves!



Plant with Tropical or Edible Plants for Food, Beauty or Both!



Built to last for many years



Adjustable Height and Leveling

The Leaning Garden:

Lean this 4' wide x 6' tall modular system against any wall and get growing..... Its drip irrigated, easily expandable and works with our **Varden** Trays and Sleeves!



Neoprene top and bottom feet allow the system to be leaned against solid structures for gardens anywhere, without fasteners and drilling.



Stabilizer Bar
installs once
in place to
prevent
tipping



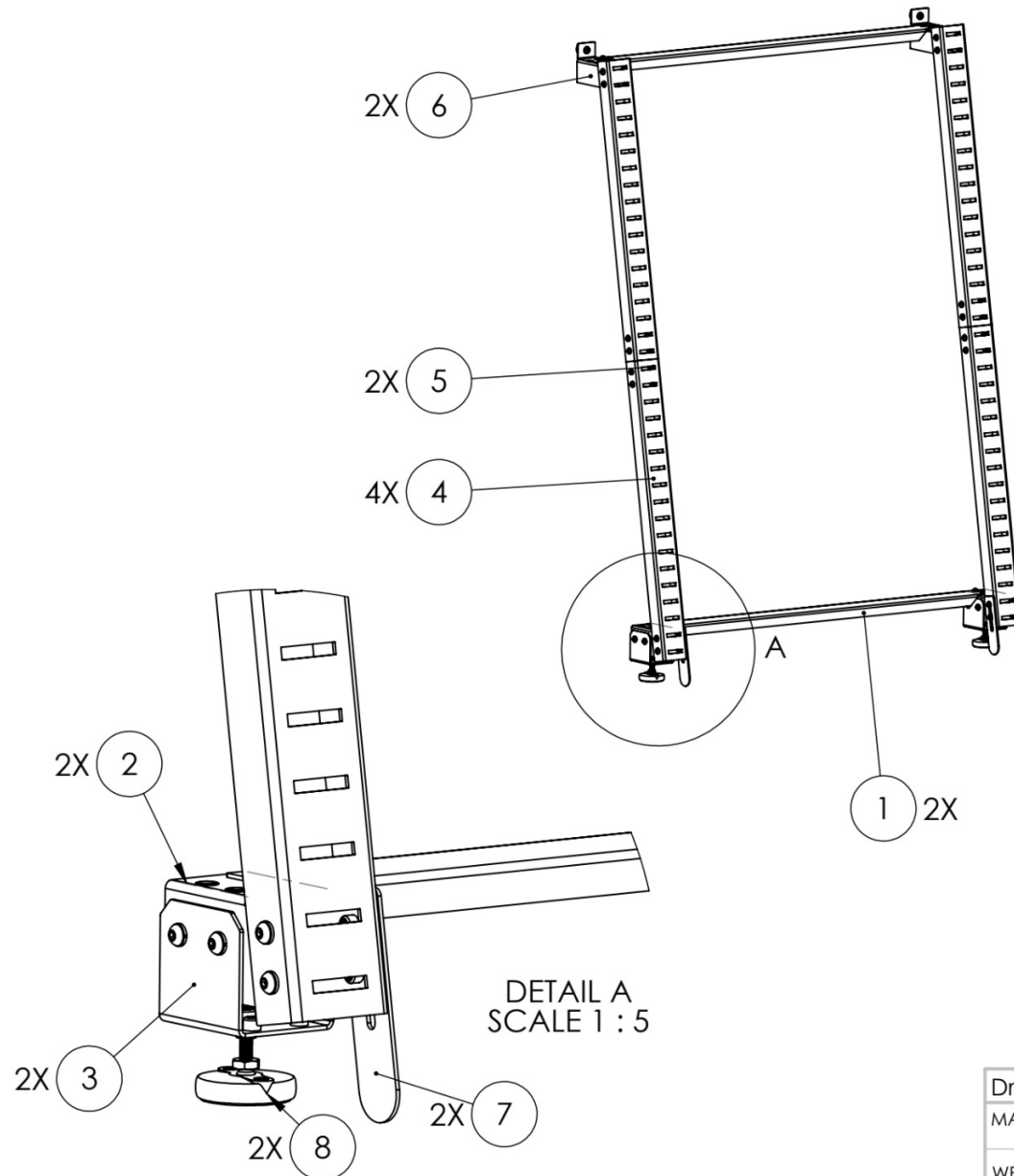

NUMBER	PART NAME
1	Spreader Bar
2	Leaver Bottom Connector
3	Floor Connector
4	Vertical Riser
5	Vertical Connector
6	Wall Connector
7	Stabilizer Bar
8	Leveling Foot



DO NOT SCALE DRAWING

Break All Edges, No Burrs

TITLE:

Varden Leaning Garden Component List

Drawn By: B. Chura

MATERIAL:

WEIGHT(lbs):

DWG NO. Leaner Component List

Rev

A

SCALE 1:20

SHEET 1 OF 2

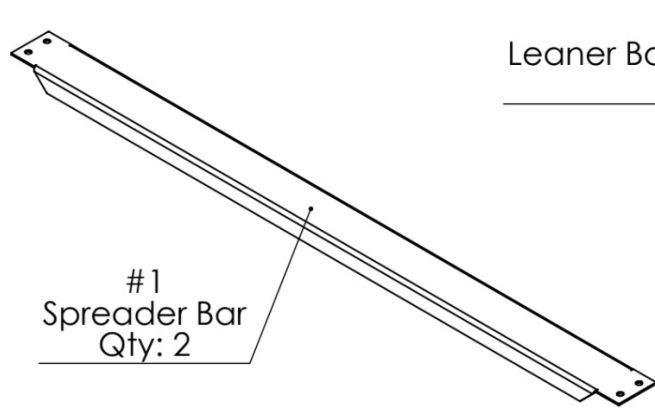

#1
Spreader Bar
Qty: 2

#2
Leaner Bottom Connector
Qty: 2

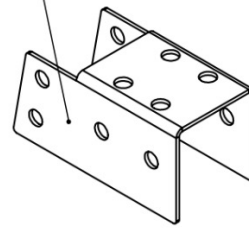

#3
Floor Connector
Qty: 2

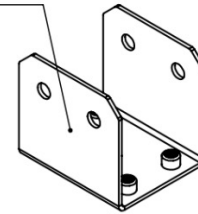

#7
Stablizer Bar
Qty: 2

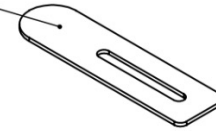

#4
Vertical Riser
Qty: 4

#6
Wall Connector
Qty: 2

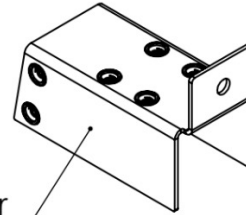

#8
Leveling Foot
Qty: 2

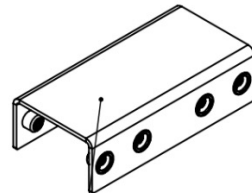

#5
Vertical Connector
Qty: 2



DO NOT SCALE DRAWING

Break All Edges, No Burrs

TITLE:

Component List

Drawn By: B. Chura

MATERIAL:

WEIGHT(lbs):

DWG NO. Leaner Component List

SCALE:1:50

SHEET 2 OF 2

Rev
A

The Rolling A-Frame:

Utilize this 4' wide x 6' tall, double-sided growing system indoors or outdoors and get growing..... Its easily expandable, irrigated and works with our **Varden** Trays and Sleeves!



Lockable casters allow the A-Frame to move around for display and gardening anywhere. Easily add grow lighting and a water basin for self-contained irrigation.



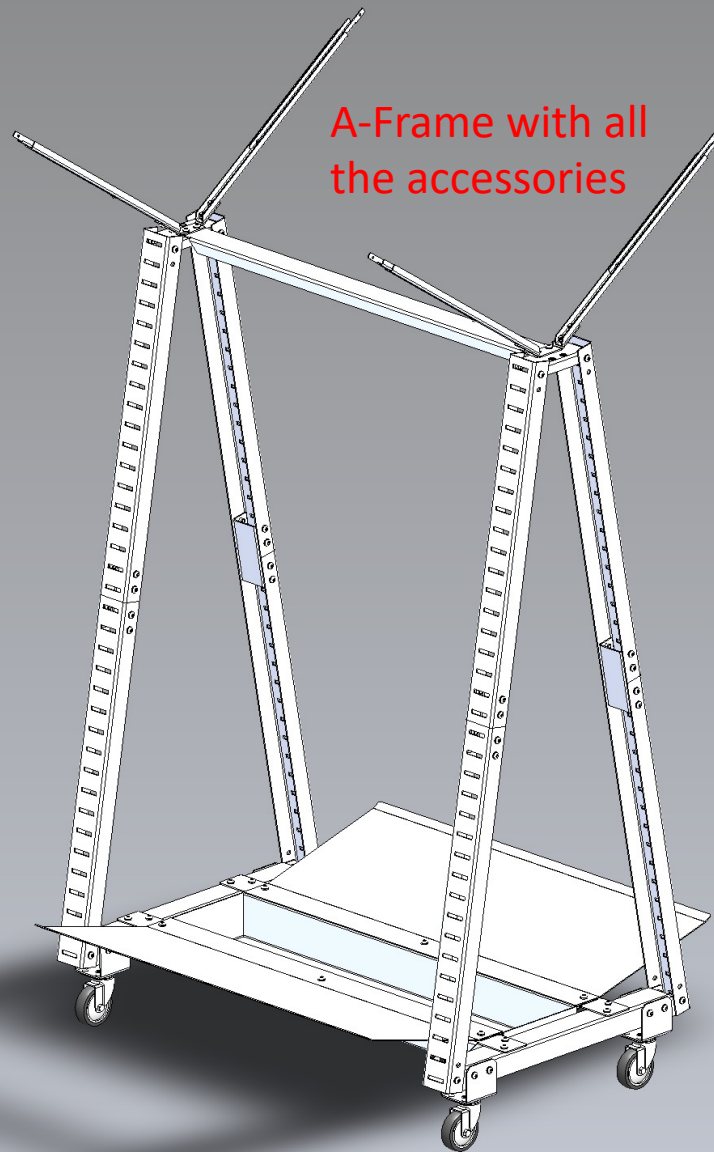

Varden 6' A-Frames Double the production and display area of the Leaning Garden even accepts basins, pumps and grow lighting!



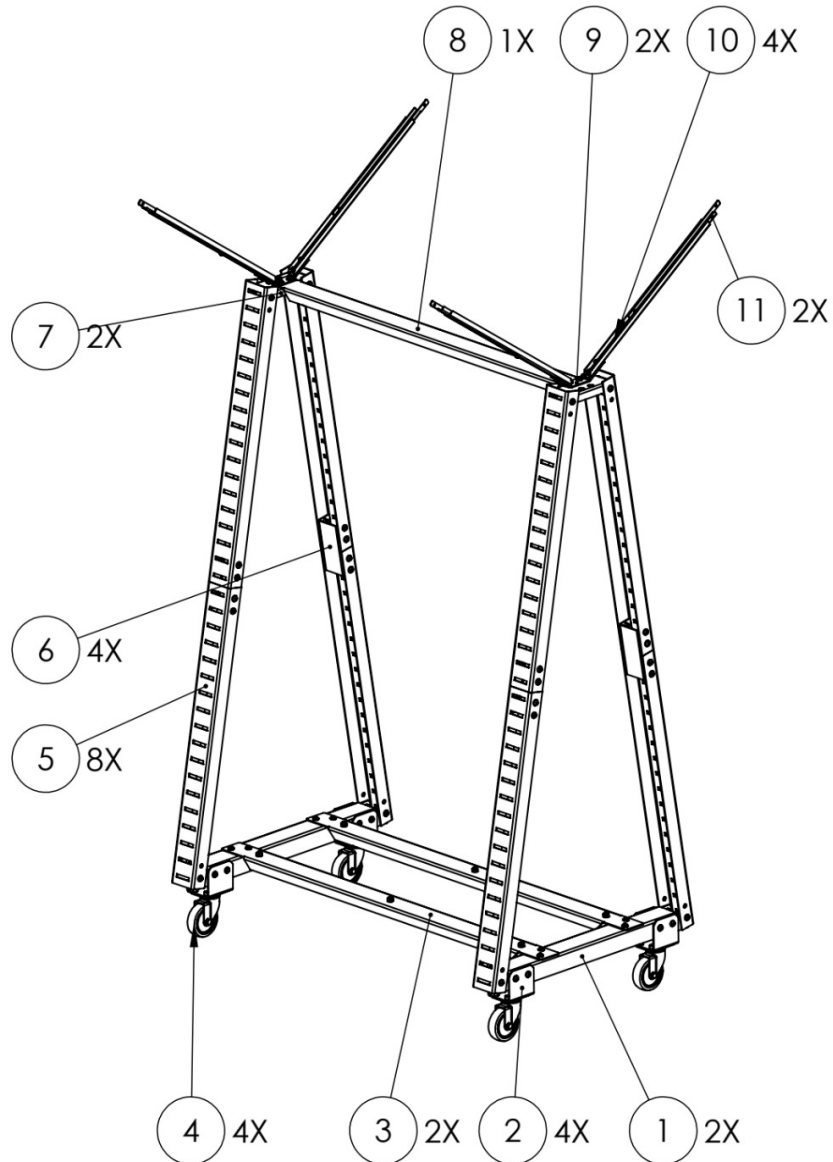

NUMBER	PART NAME
1	A-Frame Bottom Connector
2	Caster-Foot Mount
3	A-Frame Bottom Spreader
4	Caster
5	Vertical Riser
6	Vertical Connector
7	A-Frame Top Connector
8	A-Frame Top Spreader
9	Light Support Base
10	Light Support
11	Light Support Hangar



Drawn By: B. Chura

MATERIAL:

WEIGHT(lbs):

DO NOT SCALE DRAWING

Break All Edges, No Burrs

TITLE:

Varden A-Frame Component List

DWG NO. A-Frame Component List Rev

SCALE:1:50

SHEET 1 OF 3

A

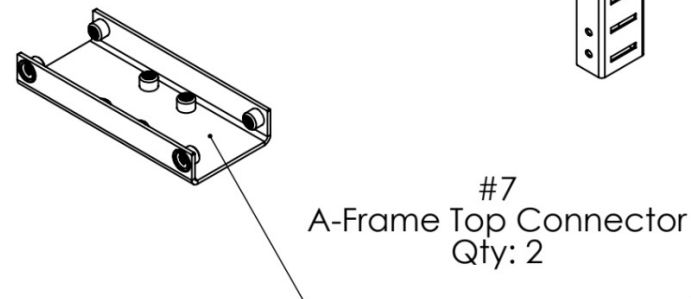
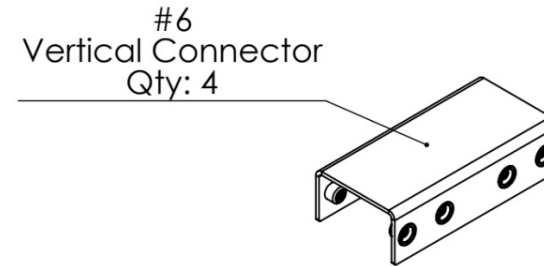
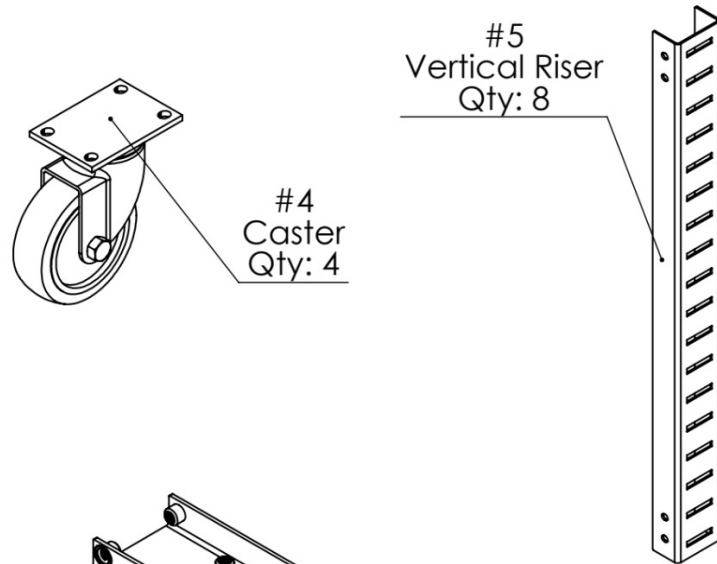
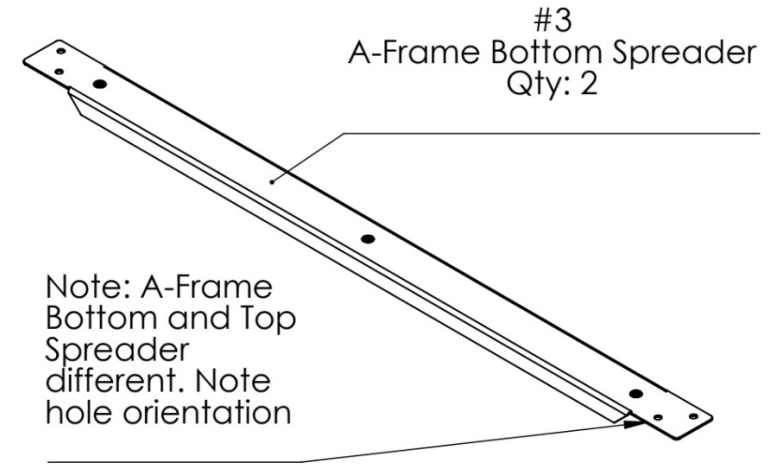
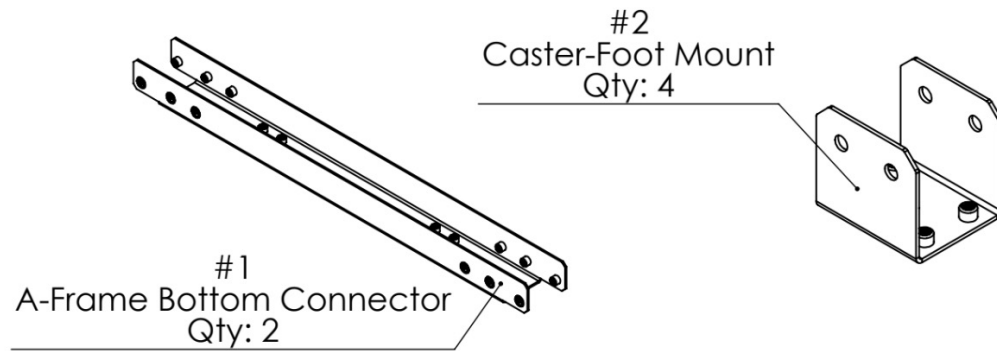

DO NOT SCALE DRAWING

Break All Edges, No Burrs

TITLE:

Component List

Drawn By: B. Chura

MATERIAL:

WEIGHT(lbs):

DWG NO. A-Frame Component List

SCALE:1:10

SHEET 2 OF 3

Rev
A



Note: A-Frame Bottom
and Top Spreader
different. Note hole
orientation

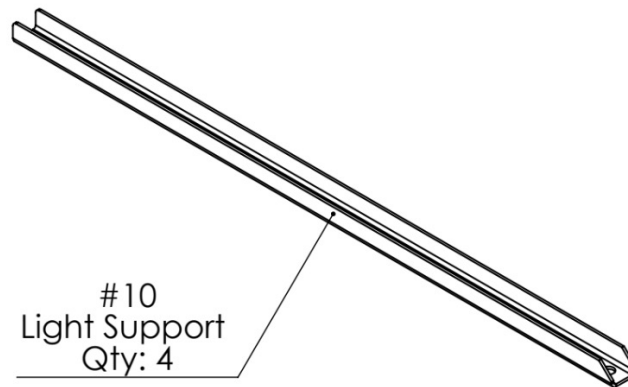
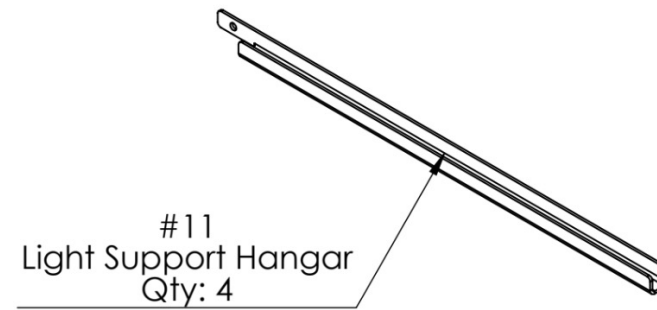

DO NOT SCALE DRAWING

Break All Edges, No Burrs

TITLE:

Component List

Drawn By: B. Chura

MATERIAL:

WEIGHT(lbs):

DWG NO.

A-Frame Component List

Rev
A

SCALE:1:10

SHEET 3 OF 3



Water basin accessory
for connecting irrigation
to a pump for mobility

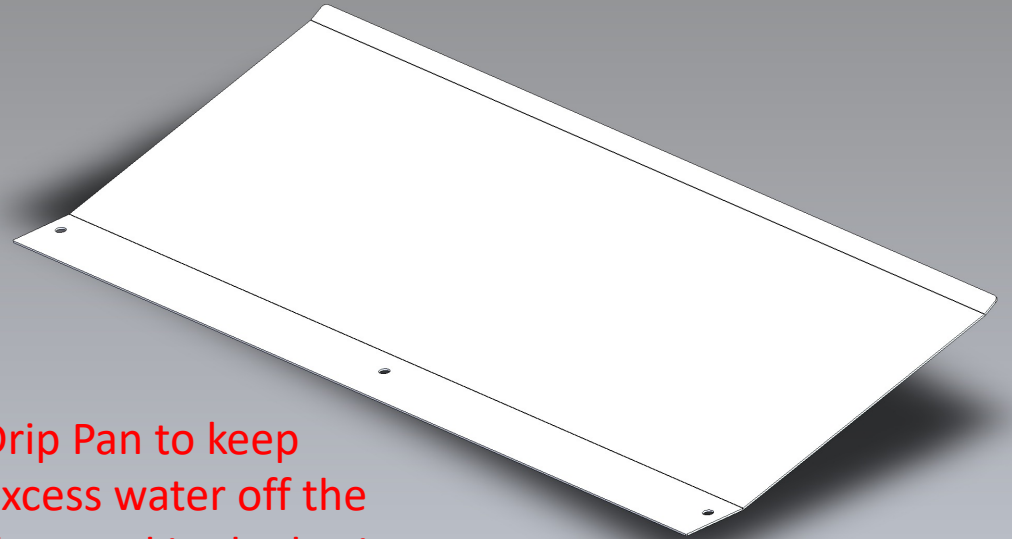

Drip Pan to keep
excess water off the
floor and in the basin



Parts Common to Assemblies

Many of the parts we use for the A-Frame Assembly are in common with parts for the Leaning Garden, Vertical Garden Racks and custom configurations as well. Easily configure taller or longer systems to suit a variety of project conditions.



Propagate,
Finish Grow,
Display, Sell,
Rotate,
Repeat!